

MATERIALE: C8/10 - egalizare
 BETON: C20/25 - infrastructura
 ARMATURA: BST500C
 OTEL: S235JR
 SURUBURI GR. 10.9

Acoperirea cu beton a armaturilor de rezistenta 5.0 cm - fundatii

Incadrare conform P100/1-2013 Cod de proiectare seismica:
 Clasa 1^a de importanta
 Amplasament seismic: Tc=0.7sec; ag=0.25g

ATENTIE!
 Executia va incepe numai dupa insusirea proiectului de catre executant si rezolvarea tuturor neclaritatilor intre acesta si proiectant.

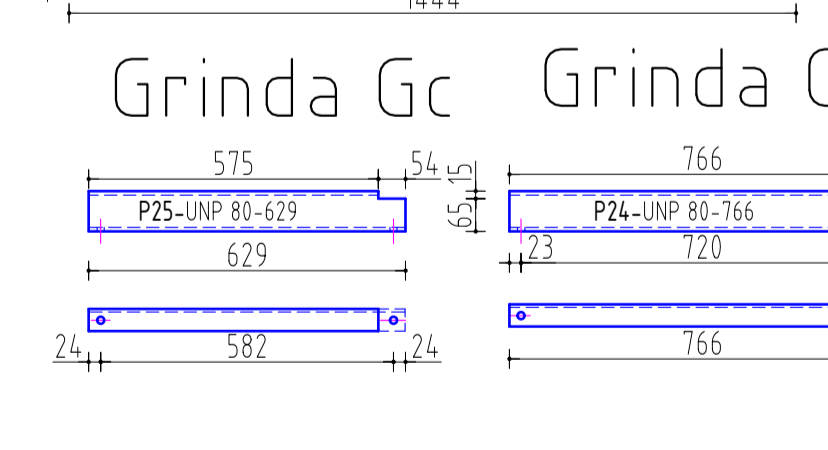
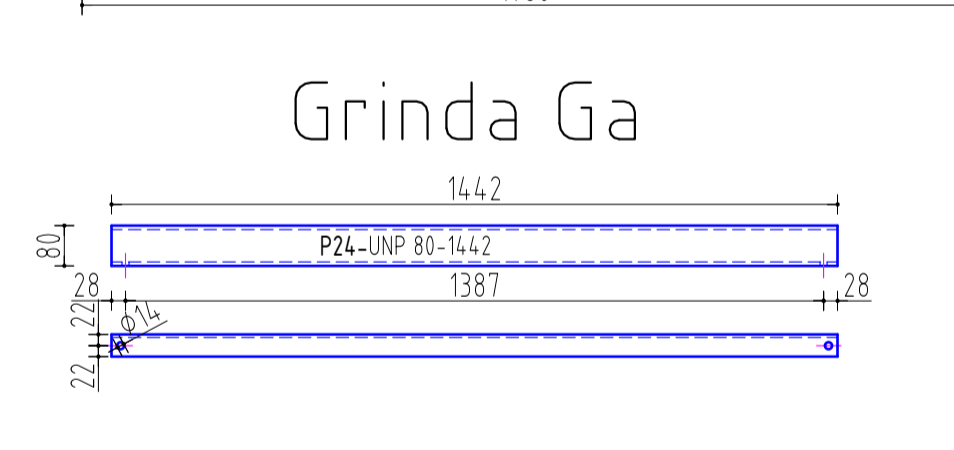
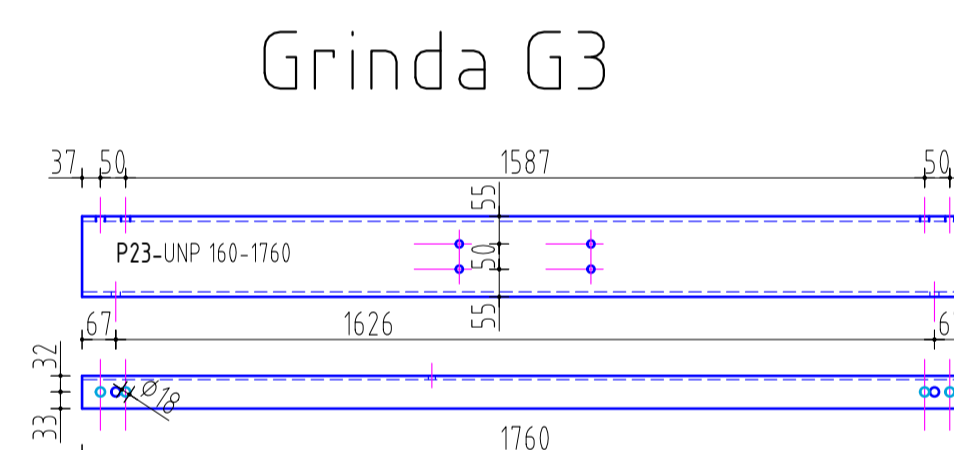
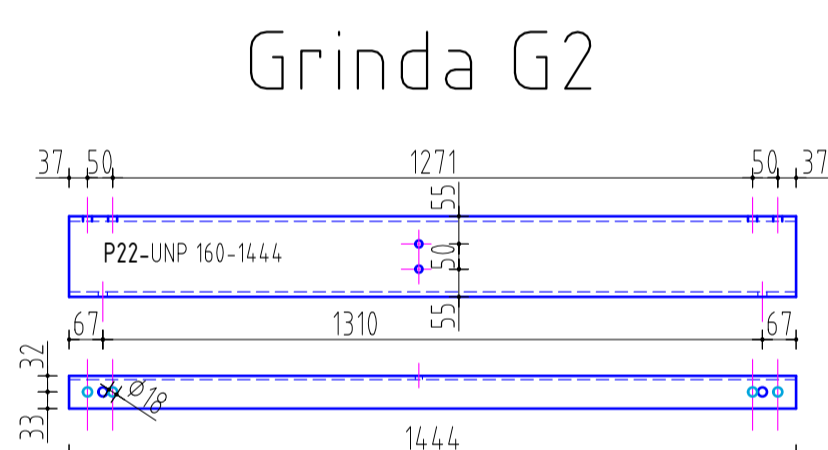
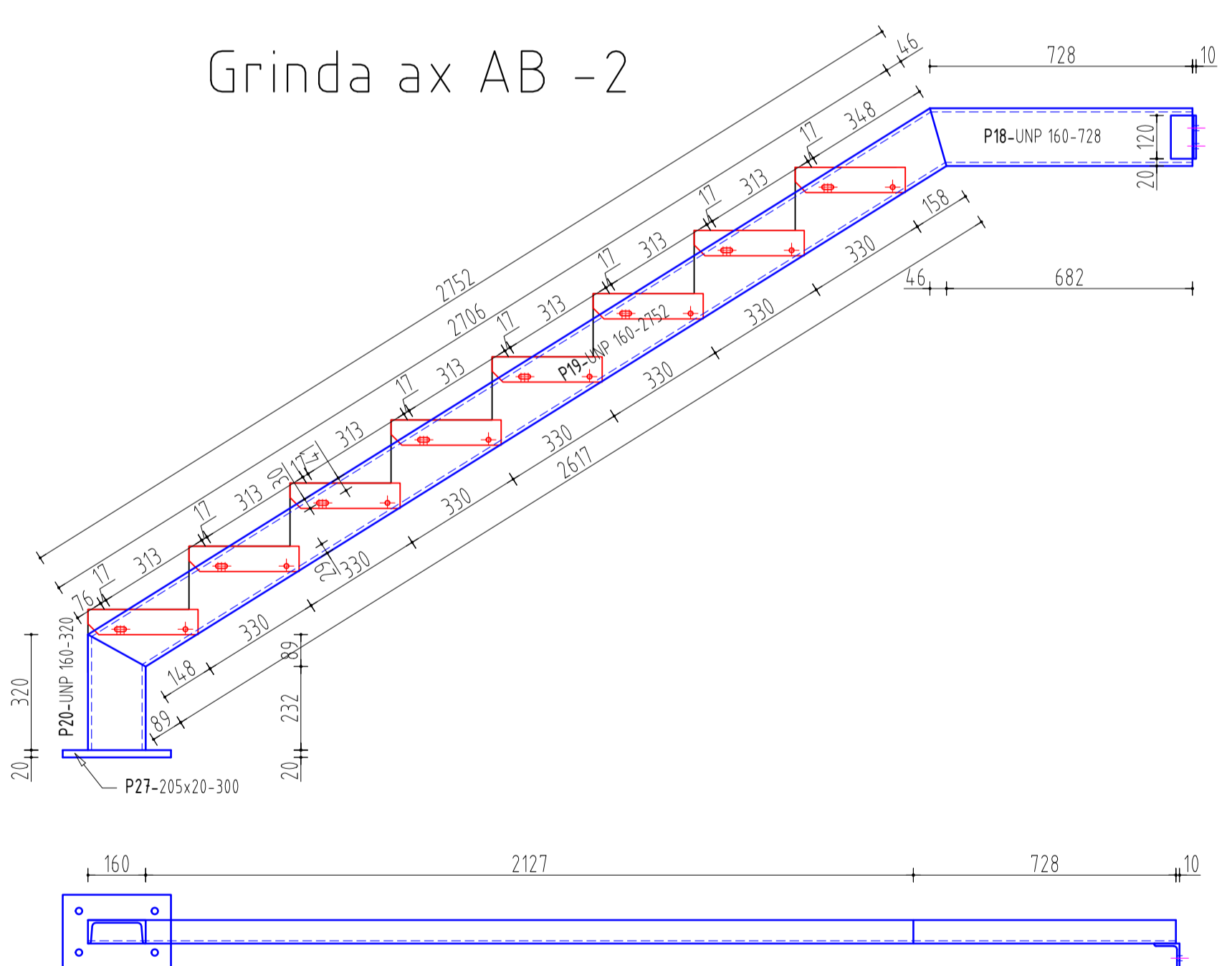

EXTRAS DE LAMINATE							
REPER	SPECIFICATIE	U.M.	CANTITATE UNITARA	BUCATI	CANTITATE TOTALA	GREUTATE pe U.M.	GREUTATE TOTALA
P1	300x20	mm	300	10	3000	47.10	141.30
P2	90x8	mm	100	60	6000	5.65	33.91
P3	TP 100x6	mm	2.976	8	23808	17.71	421.63
P4	TP 100x6	mm	1.566	2	3132	17.71	55.47
P5	270x12	mm	320	20	6400	25.43	162.78
P6	100x8	mm	130	10	1300	6.28	8.16
P7	100x8	mm	130	10	1300	6.28	8.16
P8	75x8	mm	90	40	3600	4.71	16.96
P9	200x6	mm	200	32	6400	9.42	60.29
P10	L 70x7	mm	70	42	2940	7.38	21.70
P11	185x12	mm	280	4	1120	17.43	19.52
P12	UNP 160	mm	11.338	2	22676	18.80	426.31
P13	UNP 160	mm	5.105	1	5105	18.80	95.97
P14	UNP 160	mm	2.706	2	5412	18.80	101.75
P15	UNP 160	mm	776	1	776	18.80	14.59
P16	UNP 160	mm	1.989	1	1989	18.80	37.39
P17	UNP 160	mm	588	1	588	18.80	11.05
P18	UNP 160	mm	728	1	728	18.80	13.69
P19	UNP 160	mm	2.752	2	5504	18.80	103.48
P20	UNP 160	mm	320	2	640	18.80	12.03
P21	UNP 160	mm	916	1	916	18.80	17.22
P22	UNP 160	mm	1.444	4	5776	18.80	108.59
P23	UNP 160	mm	1.760	1	1760	18.80	33.09
P24	UNP 80	mm	1.442	17	24514	8.64	211.80
P25	UNP 80	mm	629	2	1258	8.64	10.87
P26	UNP 80	mm	766	2	1532	8.64	13.24
P27	205x20	mm	300	2	600	32.19	19.31
P28	150x8	mm	232	10	2320	9.42	21.85
P29	L 70x7	mm	120	3	360	7.38	2.66
P30	410x8	mm	450	4	1800	25.75	46.35
P31	270x8	mm	560	2	1120	16.96	18.99
P32	340x8	mm	380	1	380	21.35	8.11
P33	TP 60x4	mm	1.500	4	6000	7.03	42.20
P34	TP 60x4	mm	1.880	16	30080	7.03	211.57
P35	TP 60x4	mm	800	8	6400	7.03	45.02
P36	TP 60x4	mm	550	4	2200	7.03	15.47
P37	100x6	mm	360	64	23040	4.71	108.52
TOTAL (kg)							2.701
SUZURA 2%							54
TOTAL GREUTATE (kg)							2.755

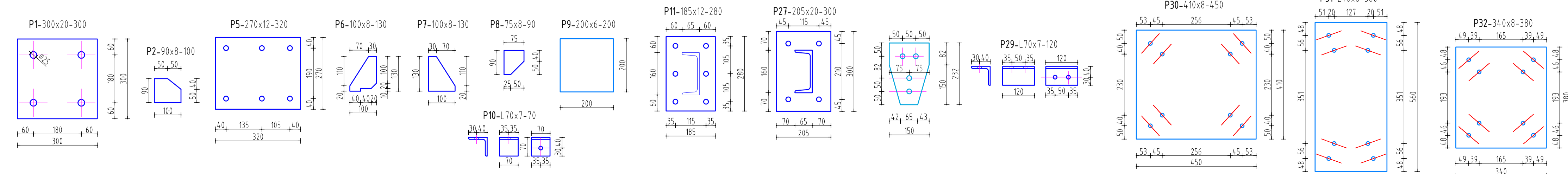

NOTA: Prezentul plan inlocuieste planul CNM183-PTh+DE-REZ-0B13-12

AMENAJAREA PUNCTULUI INTERNATIONAL DE TRECERE A FRONTIEREI DE STAT ROMANO-UCRAINEANE PENTRU PASAGERI SI MARFA IN REGIM DE BAC INTRE LOCALITATILE ISACCEA (ROMANIA) SI ORLIVKA (UCRAINA)		PROIECT CNM183	FAZA DTAC PT+DE
BENEFICIAR	SC NAVROM BAC SRL		
PROIECTANT GENERAL	S.C. TPF INGINERIE S.R.L.		CUI RO 20995401 ONRC J40/520/2010 Bd. Al. I. Cuza V. 4, et. 4, 06100, Sector 1, Bucuresti, Romania email: office@tpf.ro
SEF PROIECT	ing. B. RACU		OBIECT 13 - PASARELA C.A. PLAN GRINZI SI RAMPE
PROIECTAT	ing. D. ANDRIES		
VERIFICAT	ing. B. RACU	SCARA 1:15	CNM183-PTh+DE-REZ-0B13-12-REV01
SPECIALITATEA: REZISTENTA			DATA 09.2018