

GURA DE VARSARE - SECTIUNE
SCARA 1:50

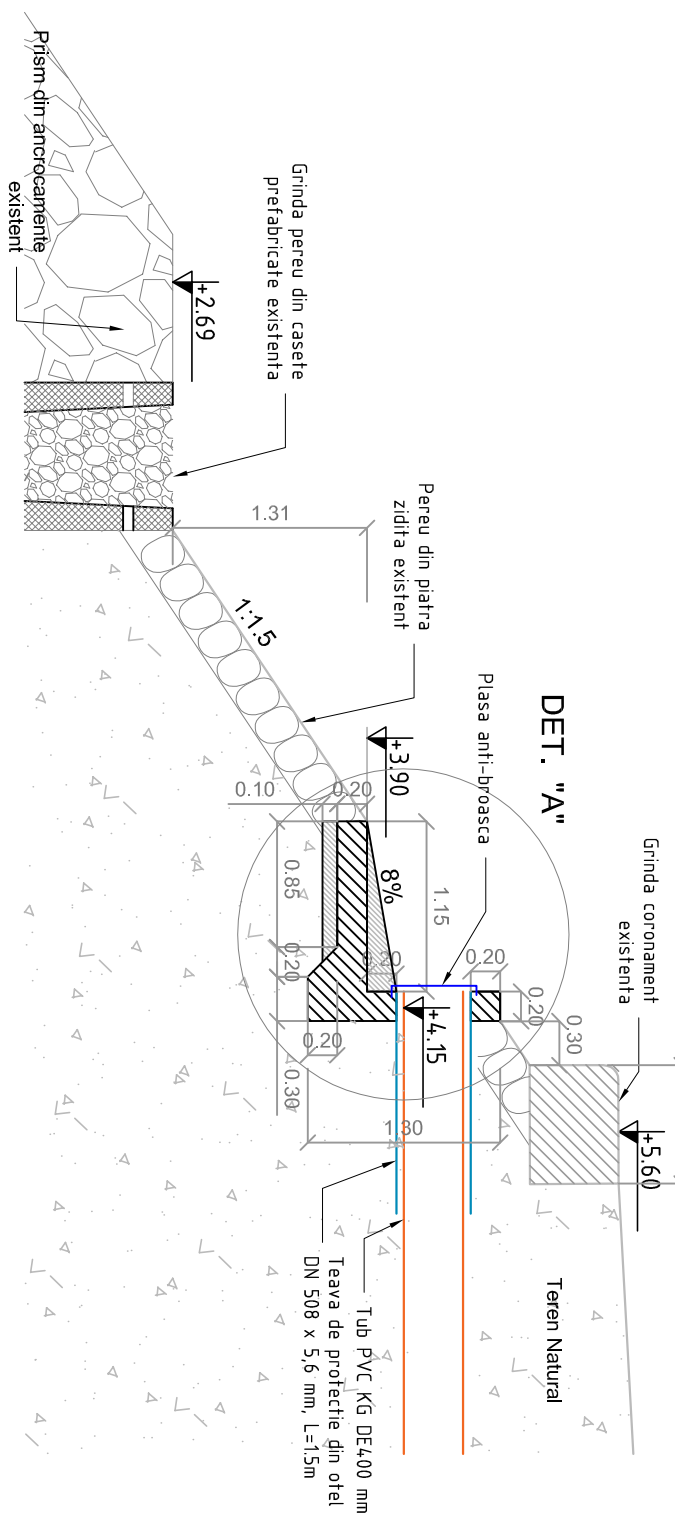

GURA DE VARSARE - VEDERE PLAN
SCARA 1:50

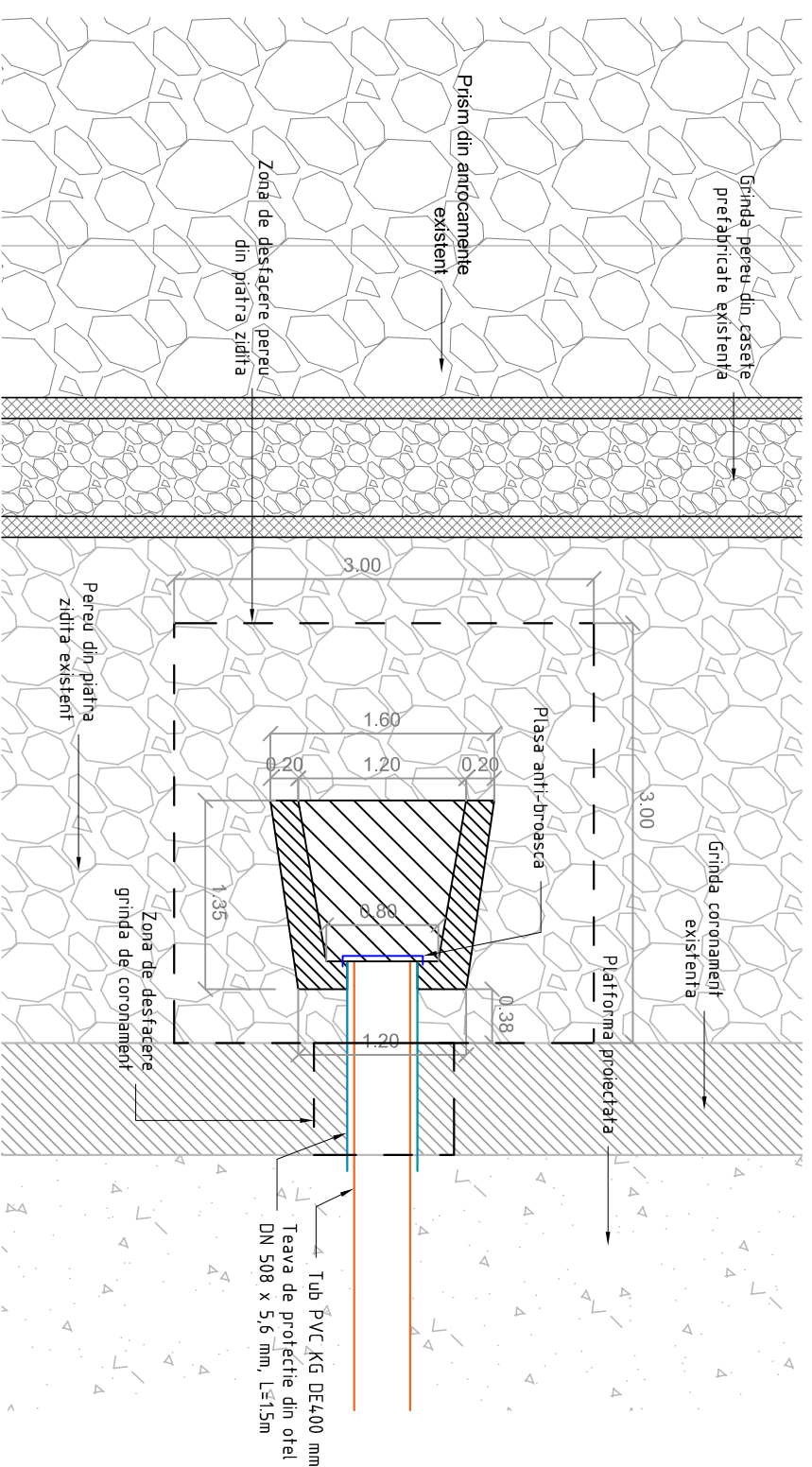

DETALIU "A"
SCARA 1:25

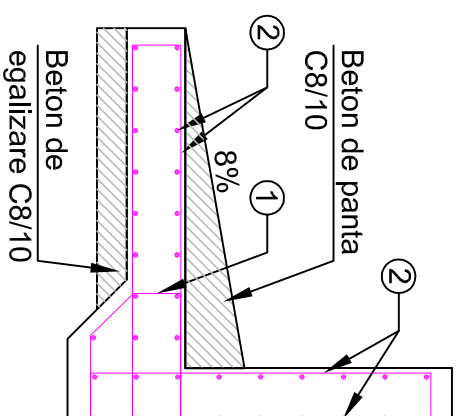

Beton de egalizare: C8/10, V = 0.11 mc
Beton armat: C16/20, V = 1.4 mc
Beton de panta: C16/20, V = 0.11 mc
Permeabilitate: 4P
Plasa sudata 100 x 100 x 8, 2 randuri, G = 45 kg
Otel beton: OB37, Ø8, 9 bucati, G = 5.5 kg
Acoperirea cu beton a armaturii = 2.5 cm

① 9 Ø8 OB 37 L=1.51,
Greutate = 5.5 kg

② Plasa sudata 100x100
Ø8, 2 randuri, Greutate =
45 kg.

SE VOR RESPECTA IN MOD OBLIGATORIU DE
CATRE "CONSTRUCTOR" NORMELE SI
LEGISLATIA DE PROTECTIA MUNCII IN VIGOARE

CLASA DE IMPORTANTA (conf. STAS 101000/0-75) C
CLASA DE CONSTRUCTIE (conf. P 100-2004) III
CLASA DE CONSTRUCTIE (conf.HG 766/1997-
Norme privind stabilirea categoriei de
importanta a constructiilor) - C

AMENAJAREA PUNCTULUI INTERNATIONAL DE TRECERE A FRONTIEREI DE STAT ROMANO-UCRANIENE PENTRU
PASAGERI SI MARFA IN REGIM DE BAC INTRE LOCALITATILE ISACCEA (ROMANIA) SI ORLYVKA (UCRAMANA)

SC NAVROM BAC SRL

S.C. TPF CPROJECT S.R.L. C.U.I. RO 26985401, ONR.C. J40/5420/2010

Sr.Elev Stefanescu, nr.6, bl. 463, sc. 1, ap. 23, sector 2, Bucuresti, Romania
email: office@tffpro

BENEFICIAR	SC NAVROM BAC SRL	PROIECT	CNM183	FAZA	PT+DE
PROIECTANT GENERAL	S.C. TPF CPROJECT S.R.L.	VERIFICAT	ing. A. STOICESCU	SCARA	1:50, 1:25
SEE PROIECT	ing. C. SANDU	SPECIALITATEA:	RETELE DE APA-CANAL	DATA	03.2017
PROIECTAT	ing. A. SEBE				
VERIFICAT	ing. A. STOICESCU				
SPECIALITATEA:	RETELE DE APA-CANAL				